

1

2

3

4

5

6

7

8

CHANGE

Revision

Date

Description

Approval

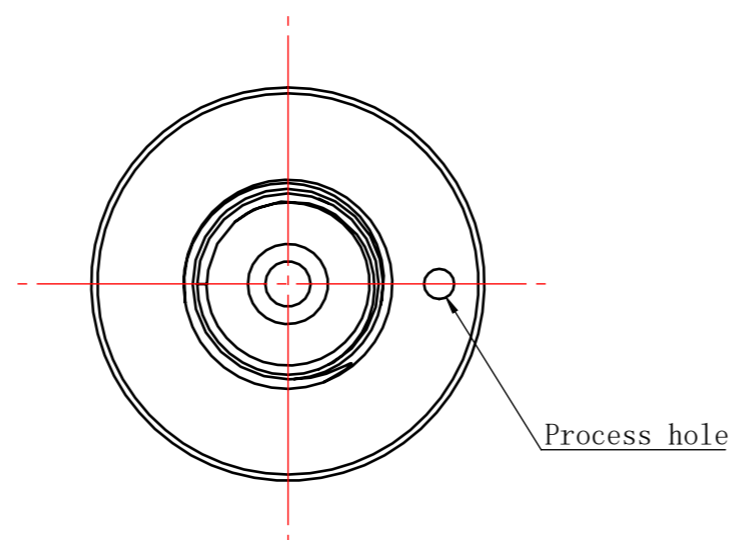
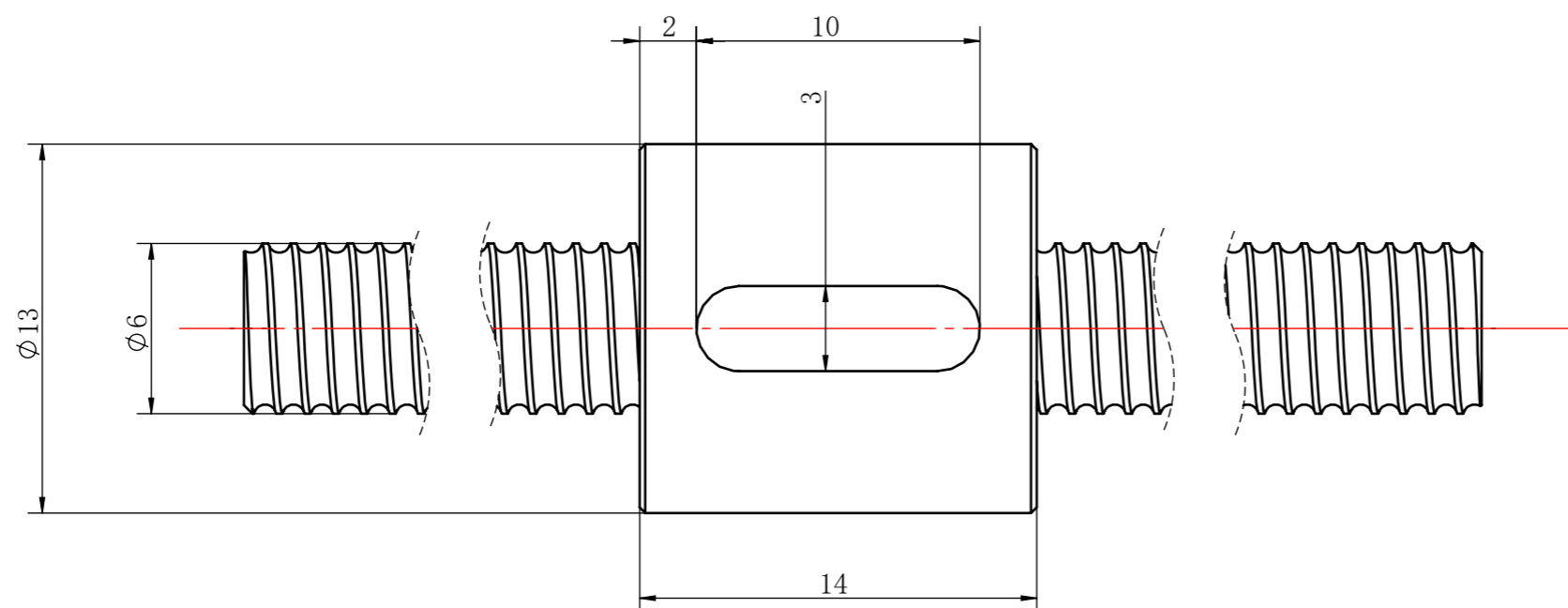

LINEAR		SPECIFICATION				CUSTOMER			
0.5~3	$\pm 0.1$	B. C. D	$\phi 6.15$	BALL SIZE	$\phi 0.8$	C. MODLE			
>3~6	$\pm 0.1$	SPACER BALL		LEAD	1	MODLE CBG0601			
>6~30	$\pm 0.2$	ALLOW ROTATION NUMBER		LEAD ANGLE		NAME BALL SCREW			
>30~120	$\pm 0.3$	LUBRICANT		NUMBER OF TURNS $\times$ ROWS		WEIGHT			
>120~400	$\pm 0.5$	O. C.	MAX. AXIAL Ca	THREAD DIRECTION/NUMBER OF THREAD		DESIGN			
>400~1000	$\pm 0.8$		MAX. RPM		DYNAMIC Ca (N)	CHECK			
>1000~2000	$\pm 1.2$	L. A.	 TRAVEL ERROR $T \pm ep$ LENGTH		STATIC Coa (N)	REV.			
ANGULAR					PRELORD TORQUE	SCALE		TOTAL:	
~10	$\pm 1^\circ$				AXIAL PLAY	UNITS		PAGE:	
>10~50	$\pm 30'$				SCREW MATERIAL	mm		RATIFY	
>50~120	$\pm 20'$				NUT MATERIAL			JIANGSU DINGS' INTELLIGENT CONTROL	
>120~400	$\pm 10'$	ACCURACY GRADE:							

1

2

3

4

5

6

7

8